

Modifications to the Engineering role.

- We have created a cut down set of reports for the Engineering Environment.

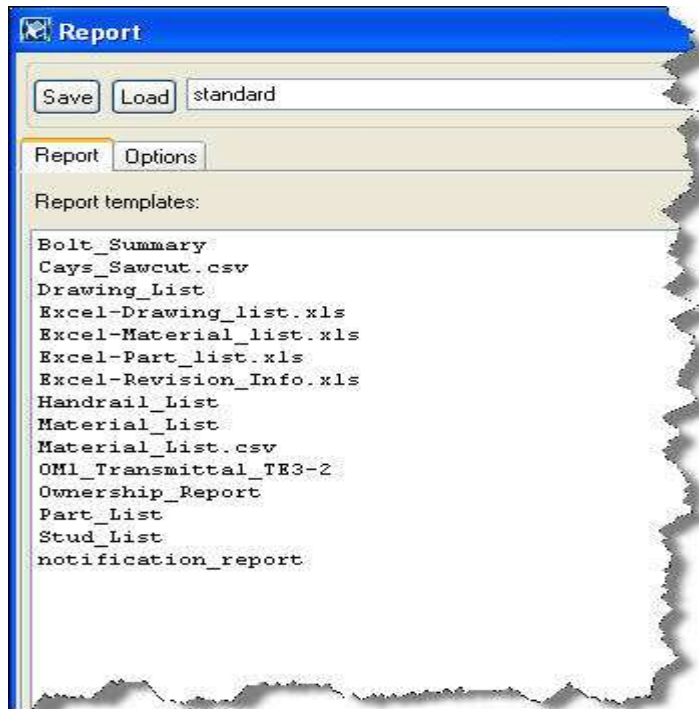

- The following GA presentations have been created & newly created title block templates have been designed. GA presentations have been revised to change the Assembly Mark to be profile and centralised them, removed the part mark bubble, removed the orientation mark, changed the view label to be an engineering style:

- A1-Engineering_Elevation.gd
- A1-Engineering_Foundation_Plan.gd
- A1-Engineering_Perspective.gd
- A1-Engineering_Plan.gd



The following Drawing View Presentations were created to match the GA presentations:

- EngineeringElevation.vi
- EngineeringPerspective.vi
- EngineeringPlan.vi
- EngineeringSection.vi
- standard.vi (copy of EngineeringSection.vi)



We have changed the view labels to be Engineering Style which includes a circle with a reference to the section name or dash if it is a plan or elevation type view in the top half of the circle, then in the lower half of the circle a reference to the drawing that the view came from if applicable.

The View labels also include the scale of the view under the label name

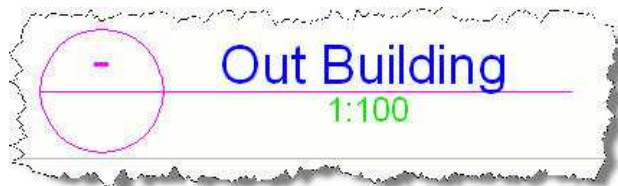

We have changed the Section Arrows to be Engineering Style with the inclusion of a reference to the drawing that the view came from if applicable. The standard.cs file was revised for this.

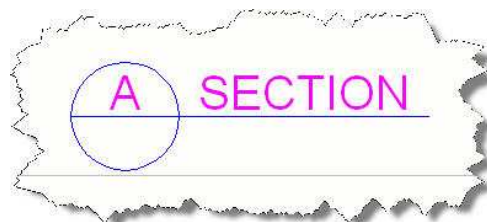
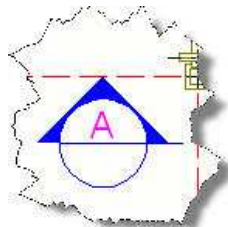

We have changed the Detail Symbol and View labels to be the Engineering style as per the sections with a circle containing the detail name and the reference to the drawing that the view came from if applicable. The standard.detail file was revised for this.

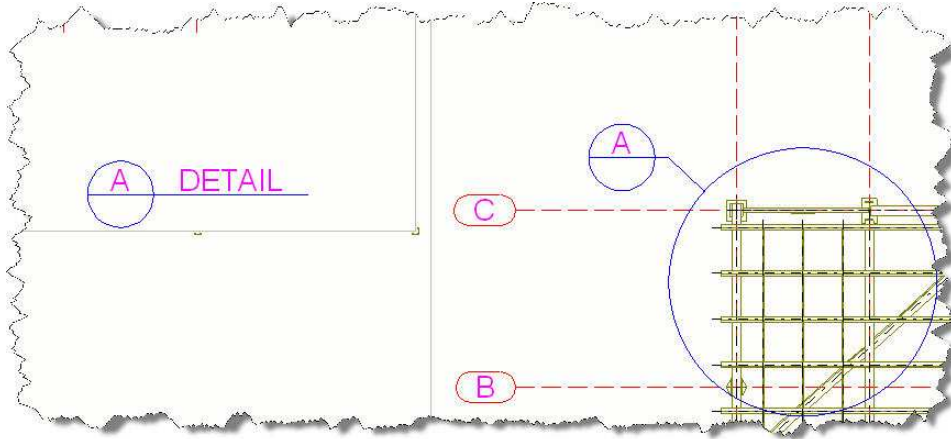

The above options are adjustable from here in the symbol or label properties:

