

6. Environment & Misc...

- We have added a search path for UEL files to the "ALL" role. This means that when you create a new model with "ALL" roles selected, it will load in all the Pre-Cast custom components.

```
set XS_UEL_IMPORT_FOLDER=%XSDATADIR%\environments\australasia\system\concrete\custom-components
```

- We have updated the following standard files for all concrete members to match industry standards:

standard.ccl (concrete column)
 standard.cpn (concrete panel)
 standard.csl (concrete slab)
 standard.rbg (rebar group)
 standard.rbm (rebar mesh)
 standard.rbr (single rebar)

- A new "Macro" called 'Design Group Numbering' has been added for TS17.0 and can be found under the 'Global' list of Macros.

This macro will allocate members of the same profile a unique identifying mark which is common for Engineering Design Drawings.

We have updated our default engineering drawings to include a new template to show this data, along with a modification to the User Defined Attributes dialog to see this data as well as a saved part mark property file so the user can turn on these marks.

The following files have been changed or added:

ENG_profile_key.tpl, ENG_profile_mark.pm, Ga.lay, ENG_ga.lay, Objects.inp

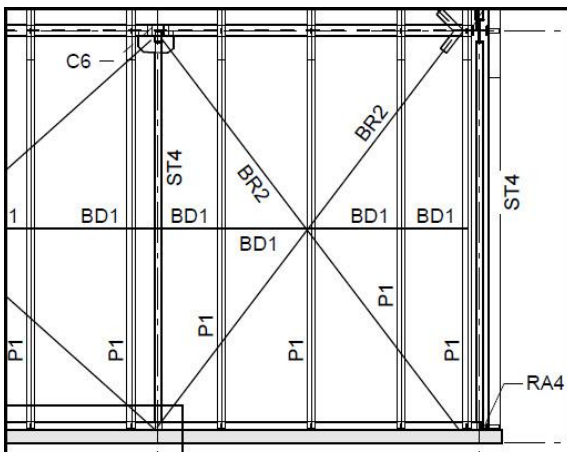

MEMBER SCHEDULE

MARK	PROFILE	COMMENT
B5	UB200*22	
B6	UB460*67	
B9	UB250*31	
BD1	LYS-HOOK-LOK-II	
BR2	EA75*75*5	
C5	SHS125*125*4.0	
C6	SHS200*200*5.0	
C8	UB250*37	
FB1	EA50*50*6	
G1	LYS-Z20019	
H4	PFC230*75	
P1	LYS-Z20019	
RA3	UA150*90*10	
RA4	EA75*75*6	
RA5	EA125*125*10	
ST4	SHS100*100*3.0	
ST5	SHS125*125*5.0	
TC2	FL12*260	